



Highlights

Shaft collars



Standard Parts. **Ganter.**

Contents

Shaft collars

Product index	→ Page	2
General notes	→ Page	4
Application examples	→ Page	5
Overview of types	→ Page	6

Shaft collars	→ Page	8
Semi-split shaft collars	→ Page	10
Quick release shaft collars	→ Page	16
Split shaft collars	→ Page	17
Accessories	→ Page	22

The publication of this catalogue renders all previous editions invalid. All editions meet the best available technology during printing. We reserve the right to make technical modifications or modifications resulting from an error as well as the right to remove individual items from the product range. The products of this catalogue were developed as standard parts with the aim of covering the widest possible spectrum of requirements. We shall not assume any responsibility or liability for special applications with extraordinary requirements on our products. Our design department will gladly answer questions on certain product features, such as missing tolerances, dimensions, and stability. We will deliver based on our terms and conditions of payment and delivery. Download is available at www.ganternorm.com. Otto Ganter GmbH & Co. KG has all rights to the catalogue. Reproduction, including excerpts, is prohibited.
Otto GANTER GmbH & Co. KG, January 2020

Shaft collars



GN 705
Shaft collars
Steel
Page 8



GN 705
**Stainless Steel-
Shaft collars**
Page 8



GN 706.2
Semi-split shaft collars
Steel / Aluminum
Page 10



GN 706.2
**Semi-split
Stainless Steel-
Shaft collars**
Page 10



GN 7062.1
**Semi-split
Stainless Steel-
Shaft collars**
extension-tapped holes
Page 11



GN 7062.2
**Semi-split
Stainless Steel-
Shaft collars**
with flange holes
Page 12



GN 7062.3
**Semi-split
Stainless Steel-
Shaft collars**
with dampening washer
Page 13



GN 706.3
Threaded shaft collars
Steel
Page 14



GN 706.3
**Threaded
Stainless Steel-
Shaft collars**
Page 14



GN 706.4
Semi-split shaft collars
with adjustable hand lever
Steel / Aluminum
Page 15



GN 706.4
Semi-split shaft collars
with adjustable hand lever
Stainless Steel
Page 15

Quick release shaft collars



GN 704
**Quick release
shaft collars**
Aluminum
Page 16

Split shaft collars



GN 707.2
Split shaft collars
Steel / Aluminum
[Page 17](#)



GN 707.2
**Split Stainless Steel-
Shaft collars**
[Page 17](#)



GN 7072.1
**Split Stainless Steel-
Shaft collars**
with extension-tapped
holes
[Page 18](#)



GN 7072.2
**Split Stainless Steel-
Shaft collars**
with flange holes
[Page 19](#)



GN 7072.3
**Split Stainless Steel-
Shaft collars**
with dampening washer
[Page 20](#)



GN 707.5
Split shaft collars
Plastic
[Page 21](#)

Accessories



GN 311
Adjustable hand levers
for shaft collars
Zinc die casting,
Stainless Steel
[Page 22](#)



GN 7062.10
**Stainless Steel-
Sensor holders**
for shaft collars
[Page 23](#)



GN 7062.30
Dampening washers
for semi-split shaft
collars
Elastomer
[Page 24](#)



GN 7072.30
Dampening washers
for split shaft collars
Elastomer
[Page 24](#)

Shaft collars can be used in multiple ways in machine and fixture fabrication: They secure shafts and axles, act as a positive stop or as an attachment option for additional function elements. Classification of shaft collars can be done based on the type of clamping as well as the assembly possibilities.

Shaft collars, simple

Shaft collars GN 705 have the simplest structure with their solid circular body and they comply with DIN 705. Clamping is done radially with a grub screw, which presses onto the surface of the shaft or axle.

This type of shaft collar can be used optimally together with a dimpled hole or a groove at the collet diameter, which ensures exact repositioning of the shaft collar and, at the same time, prevents damage to the clamping point of the shaft or axle surface.



Shaft collars, semi-split

Unilaterally semi-split shaft collars GN 706.2 are assembled axially on shafts or axles. The clamping creates a non-positive connection with the shaft or the axle along with the entire inside surface of the shaft collar. Extremely high clamping and retaining forces are achieved by reducing the slot height by clamping with the help of a socket cap screw.



Shaft collars, split

Split shaft collars GN 707.2 can be set axially as well as radially on the shaft or axle and are then held together by two socket cap screws. Clamping is done just like in case of the semi-split version, by reducing the slot height using socket cap screws. The split shaft collars GN 707.2 correspond in measurement to the semi-split version GN 706.2 so that these can be exchanged with each other in general and depending on the application.



Shaft collars with additional function

Building up on the two aforementioned types of shaft collars, shaft collars with "additional functions" are available. Additional radial or axially parallel holes, with or without thread, easily facilitate attaching rings even, for instance, as a flange or attaching other components such as sensor holders on the shaft collar. Versions having an adjustable clamping lever or a damping washer complete the program.

Clamping levers, damping washers and matching sensor holders are also available, individually as accessories or for retrofitting via a separate Ganter standard for all standards of the shaft collar families GN 706... and GN 707....





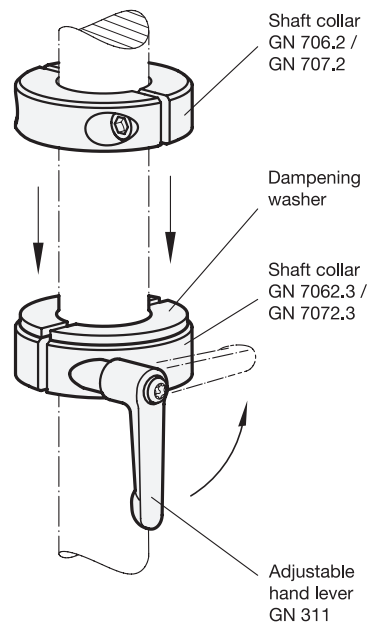
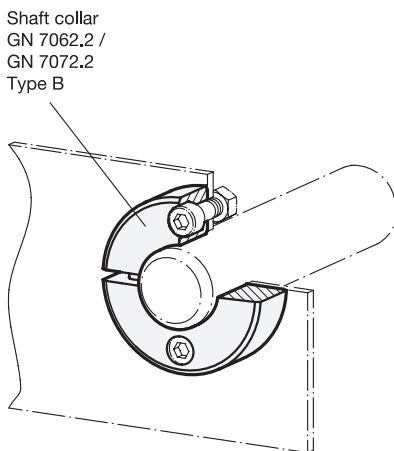
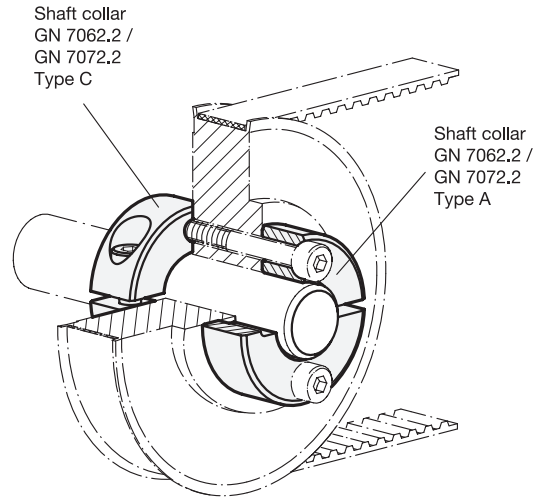
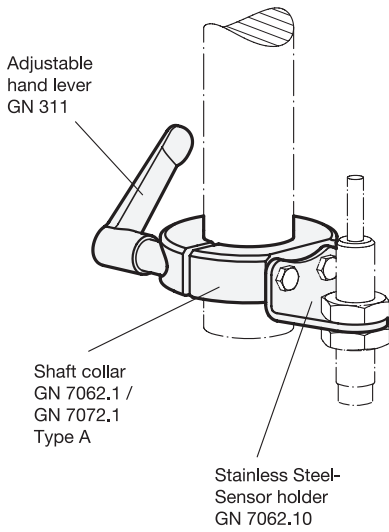

Shaft collars

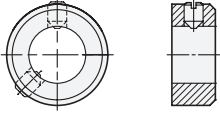
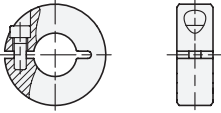
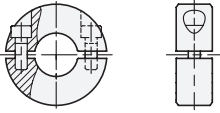
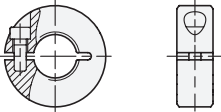
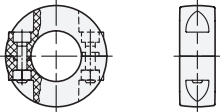
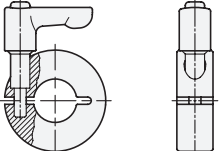
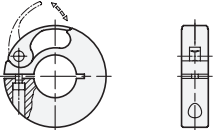
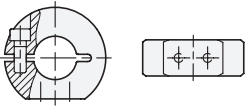
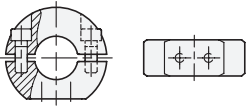
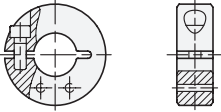
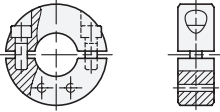
General notes

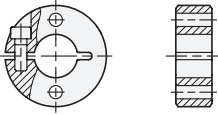
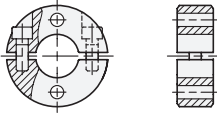
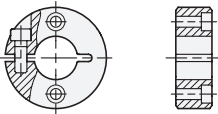
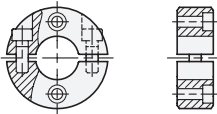
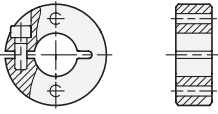
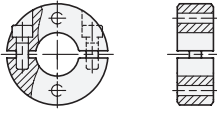
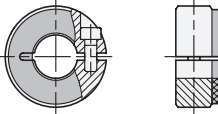
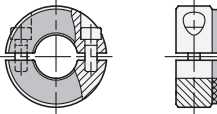
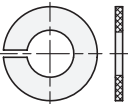

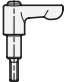
Application	Shaft collars, simple	Shaft collars, semi-split	Shaft collars, split
Universal	<ul style="list-style-type: none"> • Axial assembly • Compact design • Clamping, radial (positive) with threaded pin • Can be positioned by spot drilling on the shaft <p>GN 705 complies with DIN 705</p> 	<ul style="list-style-type: none"> • Axial assembly • Clamping by reducing the slot height using a socket cap screw • Non-positive/damage-free clamping <p>GN 706.2 Standard version</p> 	<ul style="list-style-type: none"> • Axial / radial assembly • Clamping by reducing the slot height using a socket cap screw • Non-positive/damage-free clamping <p>GN 707.2 Standard version</p> 
		<p>GN 706.3 Threaded shaft collars</p> 	<p>GN 707.5 Plastic</p> 
		<p>GN 706.4 with adjustable hand lever</p> 	
		<p>GN 704 Quick release shaft collars</p> 	
Sensor attachment		<p>GN 7062.1 - Type A Threaded holes, radial</p> 	<p>GN 7072.1 - Type A Threaded holes, radial</p> 
		<p>GN 7062.1 - Type B Threaded holes, axial</p> 	<p>GN 7072.1 - Type B Threaded holes, axial</p> 

Application	Shaft collars, semi-split	Shaft collars, split
Flange mounting	<p>GN 7062.2 - Type A with two through-holes</p> 	<p>GN 7072.2 - Type A with two through-holes</p> 
	<p>GN 7062.2 - Type B with two countersunk holes</p> 	<p>GN 7072.2 - Type B with two countersunk holes</p> 
	<p>GN 7062.2 - Type C with two threaded holes</p> 	<p>GN 7072.2 - Type C with two threaded holes</p> 
Dampening	<p>GN 7062.3 with dampening washer</p> 	<p>GN 7072.3 with dampening washer</p> 
Accessories	 <p>GN 7062.30 Dampening washers</p>	 <p>GN 7072.30 Dampening washers</p>
		 <p>GN 311 Adjustable hand levers</p>
		 <p>GN 7062.10 Stainless Steel- Sensor holders</p>

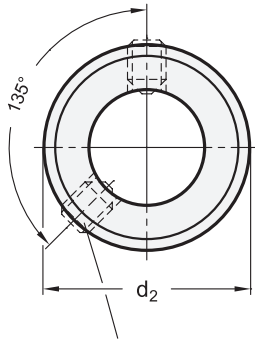

Second grub screw for size $d_1 = 80$

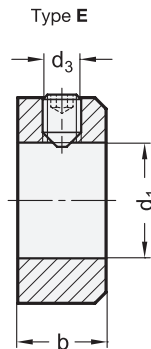
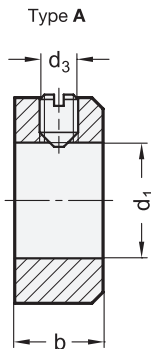

Assembly examples

Positioning through

Dimpled hole

Groove

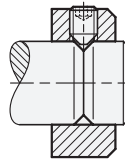
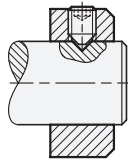

EDELSTAHL®
Rostfrei
Inox
Stainless
Steel

2 Type

- A** Grub screw with slot ISO 7434 (DIN 553)
- E** Grub screw with internal hexagon DIN 914



d_1 H8	Steel blackened Type A Type E	Steel * zinc plated ZB Type E	Stainless Steel NI Type E	d_2	d_3	b js14
5	5	5	5	10	M 3 x 4	6
6	6	6	6	12	M 4 x 5	8
7	7	7	7	12	M 4 x 5	8
8	8	8	8	16	M 4 x 6	8
9	9	9	9	18	M 5 x 8	10
10	10	10	10	20	M 5 x 8	10
11	11	11	11	20	M 5 x 8	10
12	12	12	12	22	M 6 x 8	12
13	13	13	13	22	M 6 x 8	12
14	14	14	14	25	M 6 x 8	12
15	15	15	15	25	M 6 x 8	12
16	16	16	16	28	M 6 x 8	12
18	18	18	18	32	M 6 x 8	14
20	20	20	20	32	M 6 x 8	14
22	22	22	22	36	M 6 x 10	14
24	24	24	24	40	M 8 x 12	16
25	25	25	25	40	M 8 x 10	16
26	26	26	26	40	M 8 x 10	16
28	28	28	28	45	M 8 x 12	16



d_1 H8	Steel blackened Type A Type E	Steel * zinc plated ZB Type E	Stainless Steel NI Type E	d_2	d_3	b js14
30	30	30	30	45	M 8 x 10	16
32	32	32	32	50	M 8 x 12	16
34	-	34	34	50	M 8 x 12	16
35	35	35	35	56	M 8 x 12	16
36	-	36	36	56	M 8 x 12	16
38	-	38	38	56	M 8 x 12	16
40	40	40	40	63	M 10 x 16	18
42	-	42	42	63	M 10 x 16	18
45	45	45	45	70	M 10 x 16	18
48	-	48	48	70	M 10 x 16	18
50	50	50	50	80	M 10 x 16	18
52	-	-	-	80	M 10 x 16	18
55	55	-	-	80	M 10 x 16	18
60	60	-	-	90	M 10 x 16	20
65	-	-	-	100	M 10 x 20	20
70	70	-	-	100	M 10 x 20	20
75	-	-	-	110	M 12 x 20	22
80	80	-	-	110	M 12 x 20	22

* The tolerances given in accordance with DIN 705 apply to blank shaft collars.
As a rule, the surface treatment has no detrimental effect on the proper function.



Shaft collars GN 705 → Page 856
 Semi-split shaft collars GN 706.2 → Page 858
 Split shaft collars GN 707.2 → Page 859
 Quick release shaft collars GN 704 → Page 863

Specification

- Steel blackened (Standard) —
- Steel zinc plated, blue passivated **ZB**
- Stainless Steel AISI 303 **NI**
- *ISO-Fundamental tolerances*
→ Main Catalogue Page 1479
- *Stainless Steel characteristics*
→ Main Catalogue Page 1489
- **RoHS**



Information

Shaft collars GN 705 essentially comply with the versions of DIN 705. GN 705 also contains a number of practical intermediate sizes in addition to the DIN-versions as well as Type E (grub screw with internal hexagon).

The clamping is done radially on the shaft or axle surface. Together with a dimpled hole or a groove at the collet diameter, the shaft collars can be positioned exactly and, at the same time, damage to the clamping point can be avoided.

see also...

- *Semi-split shaft collars GN 706.2 → Page 10*

How to order (Steel, blackened)	1	d ₁
GN 705-20-A	2	Type

How to order (Steel, zinc plated)	1	d ₁
GN 705-10-E-ZB	2	Type
	3	Finish

How to order (Stainless Steel)	1	d ₁
GN 705-10-E-NI	2	Type
	3	Material

Socket cap screw
DIN 912

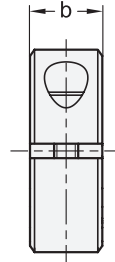
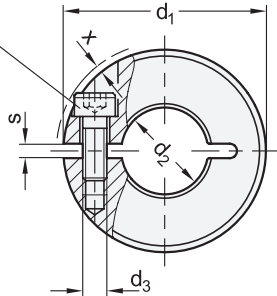

Rostfrei
Inox
Stainless
Steel

d ₁	d ₂		b ±0,2	d ₃	s		x ≈ max. protrusion of cap screw
	H10 for ST, NI, AL E8 for A4 recommended shaft tolerance h11				ST, NI, AL	A4	
20	B 6	-	9	M 3	2,1	1,6	1,2
22	B 8	-	9	M 3	2,1	1,6	1
26	B 10	-	11	M 4	2,1	1,6	1,6
30	B 12	-	11	M 4	2,1	1,6	0,7
32	B 14	-	11	M 4	2,1	1,6	0,7
36	B 15	B 16	13	M 5	2,1	1,6	1,4
42	B 18	B 20	15	M 5	3	1,6	0,6
48	B 22	B 25	15	M 5	3	1,6	0
55	B 28	B 30	15	M 6	3	1,6	0,5
60	B 32	B 35	15	M 6	4	1,6	0,4
65	B 40	-	15	M 6	4	1,6	0,5

Specification

- Steel**
 - Sintered Steel (Distaloy AB)
black oxidised with vapor
 - Socket cap screw DIN 912
Steel, phosphated
- Stainless Steel**
 - Sintered Steel AISI 316 LHC
 - Socket cap screw DIN 912-A2
 - Turned version AISI 316
weldable
 - Socket cap screw DIN 912-A4
- Aluminum**
 - ground
 - Socket cap screw DIN 912-A2
- ISO-Fundamental tolerances**
→ Main Catalogue Page 1480
- Stainless Steel characteristics**
→ Main Catalogue Page 1489

• RoHS

Accessory

- Dampening washers GN 7062.30 → Page 24

Information

ST Semi-split shaft collars GN 706.2 can safely and simply be assembled by reducing the slot height with high clamping force and thus they act, for instance, like an end stop. The surface of the shaft or the axle is not damaged.

The thread d₃ for sizes d₁ = 20 to 36 is designed as a through hole; for sizes d₁ = 42 and larger, it is designed as blind hole.

see also...

- Semi-split shaft collars GN 706.4 (with adjustable hand lever) → Page 15
- Quick release shaft collars GN 704 → Page 16
- Shaft collars GN 705 (with grub screw) → Page 8
- Semi-split Stainless Steel-Shaft collars GN 7062.2 (with flange holes) → Page 12
- Semi-split Stainless Steel-Shaft collars GN 7062.3 (with dampening washer) → Page 13

How to order

GN 706.2-55-B28-NI

1	d ₁
2	d ₂
3	Material

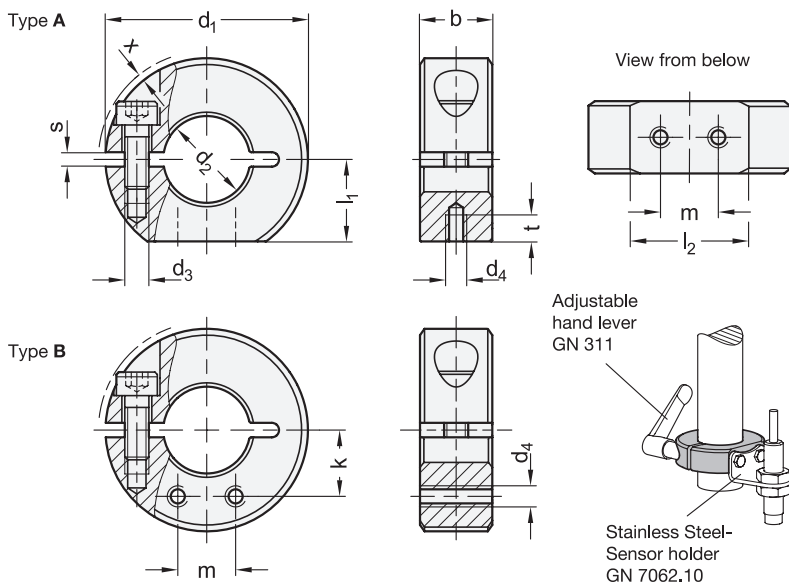

ROSTFREI
Inox
Stainless
Steel

4 Type

- A** Extension-tapped holes, radial
- B** Extension-tapped holes, axial

1 2

d ₁	d ₂ H10 recommended shaft tolerance h11 Bore series		b ±0,2	d ₃	d ₄	l ₁	l ₂	m	k		s	t	x ≈ max. protrusion of cap screw	Adjustable hand lever for d ₃
	1	2							Bore series 1	Bore series 2				
30	B 12	-	11	M 4	M 3	13	15	8	9,7	-	2,1	4	0,7	GN 311-30-M4-12-SW
32	B 14	-	11	M 4	M 3	14	15,5	8	10,8	-	2,1	4	0,7	GN 311-30-M4-12-SW
36	B 15	B 16	13	M 5	M 4	15	19,9	10	11,7	12	2,1	5,5	1,4	GN 311-30-M5-13-SW
42	B 18	B 20	15	M 5	M 4	17	24,7	12	13,7	14,3	3	5,5	0,6	GN 311-30-M5-15-SW
48	B 22	B 25	15	M 5	M 4	20	26,5	12	16,4	17,2	3	5,5	0	GN 311-45-M5-16-SW
55	B 28	B 30	15	M 6	M 5	22,5	31,6	18	18,7	19,3	3	7	0,5	GN 311-45-M6-18-SW
60	B 32	B 35	15	M 6	M 5	25	33,2	18	21,2	22	4	7	0,4	GN 311-45-M6-19-SW
65	B 40	-	15	M 6	M 5	27,5	34,6	18	24,7	-	4	7	0,5	GN 311-45-M6-20-SW

Specification

- Stainless Steel **NI**
- Sintered Steel AISI 316 LHC
- Socket cap screw DIN 912 Stainless Steel AISI 304
- ISO-Fundamental tolerances → Main Catalogue Page 1479
- Stainless Steel characteristics → Main Catalogue Page 1489
- RoHS

Accessory

- Adjustable hand levers GN 311 → Page 22
- Dampening washer GN 7062.30 → Page 24
- Stainless Steel-Sensor holder GN 7062.10 → Page 23

3

Information

With extension-tapped holes of the semi-split Stainless Steel-Shaft collars GN 7062.1, sensor holders GN 7062.10 or other elements such as the gear lever or cam can be attached to shafts and axles.

They can be assembled safely and easily with a high clamping force by reducing the slot height, without damaging the surface of shafts and axles.

The thread d₃ for sizes d₁ = 30 to 36 is designed as a through hole; for sizes d₁ = 42 and larger, it is designed as blind hole.

see also...

- Semi-split Stainless Steel-Shaft collars GN 7072.1 (with extension-tapped holes) → Page 18

How to order	1 d ₁
	2 d ₂
GN 7062.1-55-B28-NI-A	3 Material
	4 Type

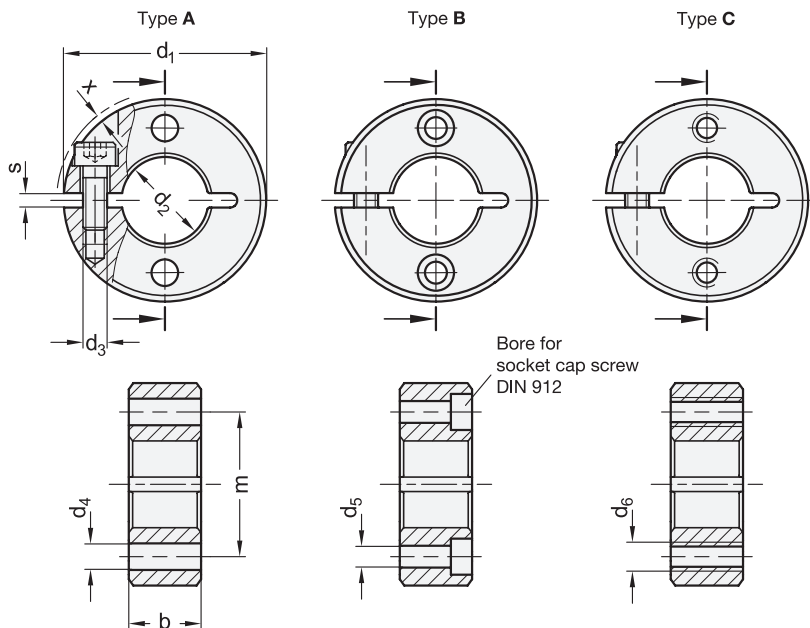

Rostfrei
Inox
Stainless
Steel

4 Type

- A** with two through holes
- B** with two countersunk holes for socket head cap screws
- C** with two tapped holes

d ₁	d ₂ H10 recommended shaft tolerance h11		b ±0,2	d ₃	d ₄	d ₅	d ₆	m		s	x ≈ max. protrusion of cap screw	Adjustable hand lever for d ₃
	Bore series 1	Bore series 2						Bore series 1	Bore series 2			
30	B 12	-	11	M 4	4,5	3,5	M 4	21	-	2,1	0,7	GN 311-30-M4-12-SW
32	B 14	-	11	M 4	4,5	3,5	M 4	23	-	2,1	0,7	GN 311-30-M4-12-SW
36	B 15	B 16	13	M 5	5,5	4,5	M 5	25,5	26	2,1	1,4	GN 311-30-M5-13-SW
42	B 18	B 20	15	M 5	5,5	4,5	M 5	30	31	3	0,6	GN 311-30-M5-15-SW
48	B 22	B 25	15	M 5	6,5	5,5	M 6	35	36,5	3	0	GN 311-45-M5-16-SW
55	B 28	B 30	15	M 6	6,5	5,5	M 6	41,5	42,5	3	0,5	GN 311-45-M6-18-SW
60	B 32	B 35	15	M 6	6,5	5,5	M 6	46	47,5	4	0,4	GN 311-45-M6-19-SW
65	B 40	-	15	M 6	6,5	5,5	M 6	52,5	-	4	0,5	GN 311-45-M6-20-SW

Specification

- Stainless Steel Sintered Steel AISI 316 LHC
- Socket cap screw DIN 912 Stainless Steel AISI 304
- ISO-Fundamental tolerances → Main Catalogue Page 1479
- Stainless Steel characteristics → Main Catalogue Page 1489
- RoHS

Accessory

- Adjustable hand levers GN 311 → Page 22
- Dampening washer GN 7062.30 → Page 24

3

Information

With semi-split Stainless Steel-Shaft collars GN 7062.2, e.g., axles are attached to housing, or wheels and washers are installed on shafts.

They can be assembled safely and easily with a high clamping force by reducing the slot height, without damaging the surface of shafts and axles.

The thread d₃ for sizes d₁ = 30 to 36 is designed as a through hole; for sizes d₁ = 42 and larger, it is designed as blind hole.

see also...

- Split Stainless Steel-Shaft collars GN 7072.2 (with flange holes) → Page 19
- Semi-split shaft collars GN 706.2 → Page 10

How to order	1	d ₁
	2	d ₂
	3	Material
	4	Type
GN 7062.2-55-B28-NI-B		

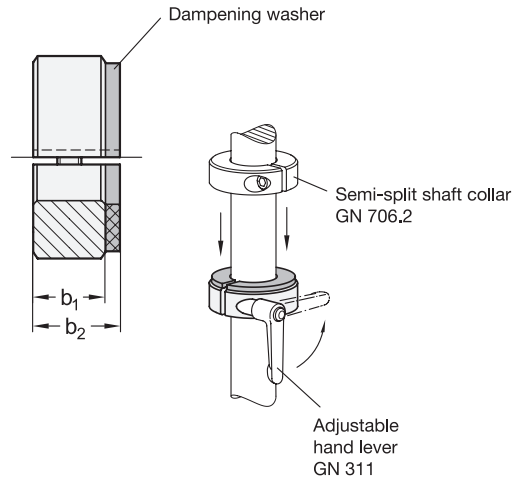
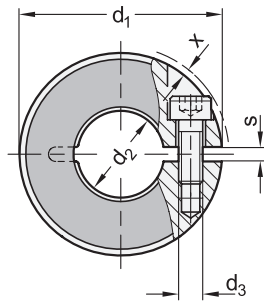

ROSTFREI
Inox
Stainless
Steel

1

2

d ₁	d ₂ H10 recommended shaft tolerance h11		b ₁	b ₂	d ₃	s	x ≈ max. protrusion of cap screw	Adjustable hand lever for d ₃ 
30	B 12	-	11	13	M 4	2,1	0,7	GN 311-30-M4-12-SW
32	B 14	-	11	13	M 4	2,1	0,7	GN 311-30-M4-12-SW
36	B 15	B 16	13	15	M 5	2,1	1,4	GN 311-30-M5-13-SW
42	B 18	B 20	15	18	M 5	3	0,6	GN 311-30-M5-15-SW
48	B 22	B 25	15	18	M 5	3	0	GN 311-45-M5-16-SW
55	B 28	B 30	15	18	M 6	3	0,5	GN 311-45-M6-18-SW
60	B 32	B 35	15	18	M 6	4	0,4	GN 311-45-M6-19-SW
65	B 40	-	15	18	M 6	4	0,5	GN 311-45-M6-20-SW

Specification

- **Stainless Steel** **NI**
Sintered Steel AISI 316 LHC
- **Dampening washer**
Elastomer (PUR)
- 70 Shore A
- temperature resistant up to 80 °C
- transparent
- **Socket cap screw DIN 912**
Stainless Steel AISI 304
- **ISO-Fundamental tolerances**
→ Main Catalogue Page 1479
- **Elastomer characteristics**
→ Main Catalogue Page 1483
- **Stainless Steel characteristics**
→ Main Catalogue Page 1489
- **RoHS**

3

Information

The affixed dampening washer of the semi-split Stainless Steel-Shaft collars GN 7062.3 absorbs mild shocks and has a sound-dampening effect when the shaft collars come into contact with other components.

They can be assembled safely and easily with a high clamping force by reducing the slot height, without damaging the surface of shafts and axles.

The thread d₃ for sizes d₁ = 30 to 36 is designed as a through hole; for sizes d₁ = 42 and larger, it is designed as blind hole.

see also...

- *Split Stainless Steel-Shaft collars GN 7072.3 (with dampening washer)* → Page 20
- *Semi-split shaft collars GN 706.2* → Page 10

Accessory

- Adjustable hand levers GN 311 → Page 22

How to order

GN 7062.3-42-B18-NI

1	d ₁
2	d ₂
3	Material

Socket cap screw
DIN 912

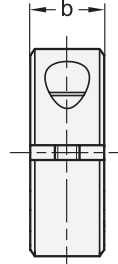
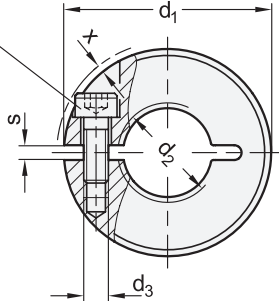

ROSTFREI
Inox
Stainless
Steel

1 d_1	2 d_2 Thread 6H recommended bolt thread tolerance 6g	$b \pm 0,2$	d_3	s	$x \approx$ max. protrusion of cap screw	Adjustable hand lever for d_3 
20	M 8 M 8 x 1	9	M 3	2,1	1	-
22	M 10 M 10 x 1	9	M 3	2,1	0,8	-
26	M 12 M 12 x 1,5	11	M 4	2,1	1,6	-
32	M 16 M 16 x 1,5	11	M 4	2,1	0,7	GN 311-30-M4-12-SW
42	M 20 M 20 x 1,5	15	M 5	3	0,6	GN 311-30-M5-15-SW
48	- M 24 x 1,5	15	M 5	3	0	GN 311-45-M5-16-SW
55	- M 30 x 1,5	15	M 6	3	0,4	GN 311-45-M6-18-SW

Specification

- Steel **ST**
 - Sintered Steel
black oxidised with vapor
 - Socket cap screw DIN 912
Steel, phosphated
- Stainless Steel (Sintered Steel) **NI**
 - AISI 316 LHC
 - Socket cap screw DIN 912
Stainless Steel AISI 304
- Metric ISO thread
→ Main Catalogue Page 1477
- Metric ISO fine thread
→ Main Catalogue Page 1478
- Stainless Steel characteristics
→ Main Catalogue Page 1489

• RoHS

Accessory

- Adjustable hand levers GN 311 → Page 22
- Dampening washers GN 7062.30 → Page 24

Information

Threaded shaft collars GN 706.3 correspond in outer dimensions to the semi-split shaft collars GN 706.2. The bore has, however, a female thread so that the clamping ring can be screwed in like a nut, for instance, to a spindle thread in order to limit the adjustment range or the screw-in depth. The clamping is then done by reducing the slot height without damaging the thread.

The thread d_3 for sizes $d_1 = 20$ to 32 is designed as a through hole; for sizes $d_1 = 42$ and larger, it is designed as blind hole.

How to order (Steel)	
1 d_1	
2 d_2	
3 Material	

GN 706.3-32-M16-ST

How to order (Stainless Steel)	
1 d_1	
2 d_2	
3 Material	

GN 706.3-42-M20x1,5-NI

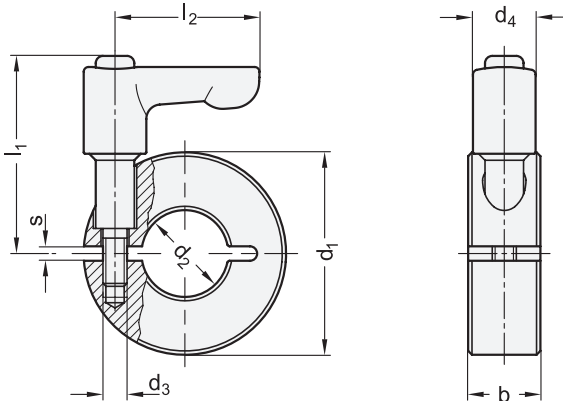

d₁	d₂ H10 recommended shaft tolerance h11	b ±0,2	d₃	d₄	l₁	l₂	s
32	B 14	-	M 4	13	37	30	2,1
36	B 15	B 16	M 5	13	38,5	30	2,1
42	B 18	B 20	M 5	13	41	30	3
48	B 22	B 25	M 5	13	43	45	3
55	B 28	B 30	M 6	13	45	45	3
60	B 32	B 35	M 6	13	46,5	45	4
65	B 40	-	M 6	13	47,5	45	4

Specification

- Steel** **ST**
Sintered Steel
black oxidised with vapor
- Stainless Steel** **NI**
Sintered Steel AISI 316 LHC
- Aluminum** **AL**
ground
- Adjustable hand levers
 - Zinc die casting
plastic coated
black RAL 9005, textured finish
 - Screw insert and retaining screw
Stainless Steel AISI 303
- ISO-Fundamental tolerances
→ Main Catalogue Page 1479
- Stainless Steel characteristics
→ Main Catalogue Page 1489

• RoHS

Accessory

- Dampening washers GN 7062.30 → Page 24

Information

Semi-split shaft collars GN 706.4 can safely and simply be clamped by reducing the slot height by using an adjustable clamping lever and thus they act, for instance, like an end stop. This version offers great advantages especially for applications that demand new positions of the shaft collar.

The thread d₃ for sizes d₁ = 32 and 36 is designed as a through hole; for sizes d₁ = 42 and larger, it is designed as blind hole.

see also...

- Semi-split shaft collars GN 706.2 (with socket head cap screw)

→ Page 10

How to order

GN 706.4-36-B16-AL

1	d ₁
2	d ₂
3	Material

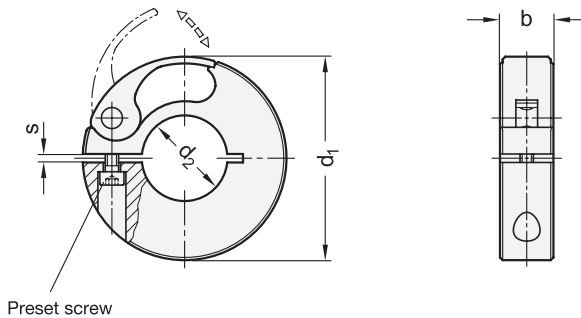

d ₁	d ₂ recommended shaft tolerance h8							b	s	Tightening torque of the screw in Nm ≈	Axial load in N ≈	
	B 6	B 8	B 10	B 12	B 14	B 15	B 16				min.	max.
38	B 6	B 8	B 10	B 12	B 14	B 15	B 16	10	1,5	0,5	133	267
50	B 20	B 25	B 28	B 30	-	-	-	13	1,5	0,7	311	445
75	B 32	B 35	B 38	-	-	-	-	15	1,5	1,5	467	534
100	B 40	B 42	B 45	B 48	B 50	-	-	19	4,5	4,5	556	867
120	B 54	B 55	B 60	B 65	B 70	B 75	-	19	4,5	4,5	890	1379

Specification

- Ring
Aluminum
black anodized
- Lever
Aluminum
yellow anodized
- ISO-Fundamental tolerances
→ Main Catalogue Page 1479
- RoHS

Information

Quick release shaft collars GN 704 are clamped by reducing the slot height using an eccentric lever. That allows the collars to be adjusted easily and quickly without tools. The aluminum design delivers low inertia values.

The specified tightening torque of the screw is a recommended value with which the collar clamped to a shaft (with closed eccentric lever) is capable of reaching the specified axial load capacity. The details on axial load capacity are non-binding guidance values and do not constitute a warranty of characteristics.

Keeping the friction surface of the eccentric lever slightly greased will help to prolong the useful service life.

see also...

- Semi-split shaft collars GN 706.2 (with socket head cap screw)

→ Page 10

How to order	1	d ₁
	2	d ₂

GN 704-38-B16

Socket cap screw
DIN 912

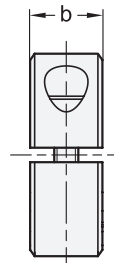
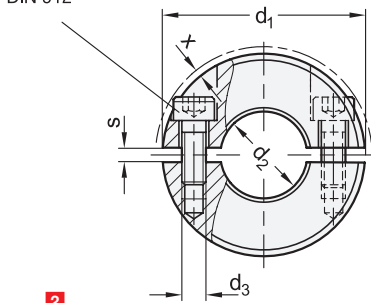

ROSTFREI
Inox
Stainless
Steel

d ₁	d ₂		b ±0,2	d ₃	s		x ≈ max. protrusion of cap screw	Adjustable hand lever for d ₃
	H10 for ST, NI, AL E8 for A4 recommended shaft tolerance h11				ST, NI, AL	A4		
20	B 6	-	9	M 3	2,1	1,6	1,2	-
22	B 8	-	9	M 3	2,1	1,6	1	-
26	B 10	-	11	M 4	2,1	1,6	1,6	-
30	B 12	-	11	M 4	2,1	1,6	0,7	GN 311-30-M4-12-SW
32	B 14	-	11	M 4	2,1	1,6	0,7	GN 311-30-M4-12-SW
36	B 15	B 16	13	M 5	2,1	1,6	1,4	GN 311-30-M5-13-SW
42	B 18	B 20	15	M 5	3	1,6	0,6	GN 311-30-M5-15-SW
48	B 22	B 25	15	M 5	3	1,6	0	GN 311-45-M5-16-SW
55	B 28	B 30	15	M 6	3	1,6	0,5	GN 311-45-M6-18-SW
60	B 32	B 35	15	M 6	4	1,6	0,4	GN 311-45-M6-19-SW
65	B 40	-	15	M 6	4	1,6	0,5	GN 311-45-M6-20-SW

Specification

- Steel**
 - Sintered Steel (Distaloy AB) black oxidised with vapor
 - Socket cap screw DIN 912 Steel, phosphated
- Stainless Steel**
 - Sintered Steel AISI 316 LHC Socket cap screw DIN 912-A2
 - Turned version AISI 316 weldable Socket cap screw DIN 912-A4
- Aluminum**
 - ground
 - Socket cap screw DIN 912-A2
- ISO-Fundamental tolerances** → Main Catalogue Page 1480
- Stainless Steel characteristics** → Main Catalogue Page 1489
- RoHS**

Accessory

- Adjustable hand levers GN 311 → Page 22
- Dampening washers GN 7072.30 → Page 24

Information

Split shaft collars GN 707.2 correspond in measurement to the semi-split shaft collars GN 706.2. They are used when an axial assembly is not possible. They are used when the latter cannot be slipped over a shaft.

For size d₁ = 20 to 36 d₃ is a through hole; starting from d₁ = 42 d₃ is a threaded blind bore.

These shaft collars not only serve as an end stop, but they can also be used for fixing or triggering other components such as end limit switches.

see also...

- Split Stainless Steel-Shaft collars GN 7072.1 (with extension-tapped holes) → Page 18
- Split Stainless Steel-Shaft collars GN 7072.2 (with flange holes) → Page 19
- Split Stainless Steel-Shaft collars GN 7072.3 (with dampening washer) → Page 20
- Split shaft collars GN 707.5 (Plastic) → Page 21

How to order

GN 707.2-65-B40-ST

1	d ₁
2	d ₂
3	Material

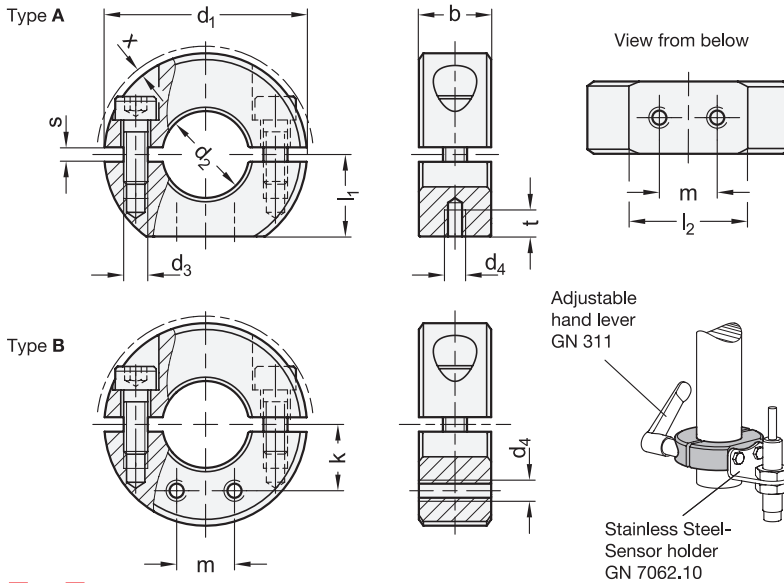

ROSTFREI
Inox
Stainless
Steel

4 Type

- A** Extension-tapped holes, radial
- B** Extension-tapped holes, axial

1 2

d ₁	d ₂ H10 recommended shaft tolerance h11 Bore series		b ±0,2	d ₃	d ₄	l ₁	l ₂	m	k		s	t	x ≈ max. protrusion of cap screw	Adjustable hand lever for d ₃
	1	2							Bore series 1	Bore series 2				
30	B 12	-	11	M 4	M 3	13	15	8	9,7	-	2,1	4	0,7	GN 311-30-M4-12-SW
32	B 14	-	11	M 4	M 3	14	15,5	8	10,8	-	2,1	4	0,7	GN 311-30-M4-12-SW
36	B 15	B 16	13	M 5	M 4	15	19,9	10	11,7	12	2,1	5,5	1,4	GN 311-30-M5-13-SW
42	B 18	B 20	15	M 5	M 4	17	24,7	12	13,7	14,3	3	5,5	0,6	GN 311-30-M5-15-SW
48	B 22	B 25	15	M 5	M 4	20	26,5	12	16,4	17,2	3	5,5	0	GN 311-45-M5-16-SW
55	B 28	B 30	15	M 6	M 5	22,5	31,6	18	18,7	19,3	3	7	0,5	GN 311-45-M6-18-SW
60	B 32	B 35	15	M 6	M 5	25	33,2	18	21,2	22	4	7	0,4	GN 311-45-M6-19-SW
65	B 40	-	15	M 6	M 5	27,5	34,6	18	24,7	-	4	7	0,5	GN 311-45-M6-20-SW

Specification

- Stainless Steel **NI**
Sintered Steel AISI 316 LHC
- Socket cap screw DIN 912
Stainless Steel AISI 304
- ISO-Fundamental tolerances
→ Main Catalogue Page 1479
- Stainless Steel characteristics
→ Main Catalogue Page 1489
- RoHS

Accessory

- Adjustable hand levers GN 311 → Page 22
- Dampening washer GN 7072.30 → Page 24
- Stainless Steel-Sensor holder GN 7062.10
→ Page 23

3

Information

With extension-tapped holes of the split Stainless Steel-Shaft collars GN 7072.1, sensor holders GN 7062.10 or other elements such as the gear lever or cam can be attached to shafts and axles.

They can be assembled safely and easily with a high clamping force by reducing the slot height, without damaging the surface of shafts and axles. As compared to semi-split shaft collars, split shaft collars can even be assembled radially.

The thread d₃ for sizes d₁ = 30 to 36 is designed as a through hole; for sizes d₁ = 42 and larger, it is designed as blind hole.

see also...

- Semi-split Stainless Steel-Shaft collars GN 7062.1 (with extension-tapped holes) → Page 11

How to order	1 d ₁
	2 d ₂
GN 7072.1-42-B18-NI-A	3 Material
	4 Type

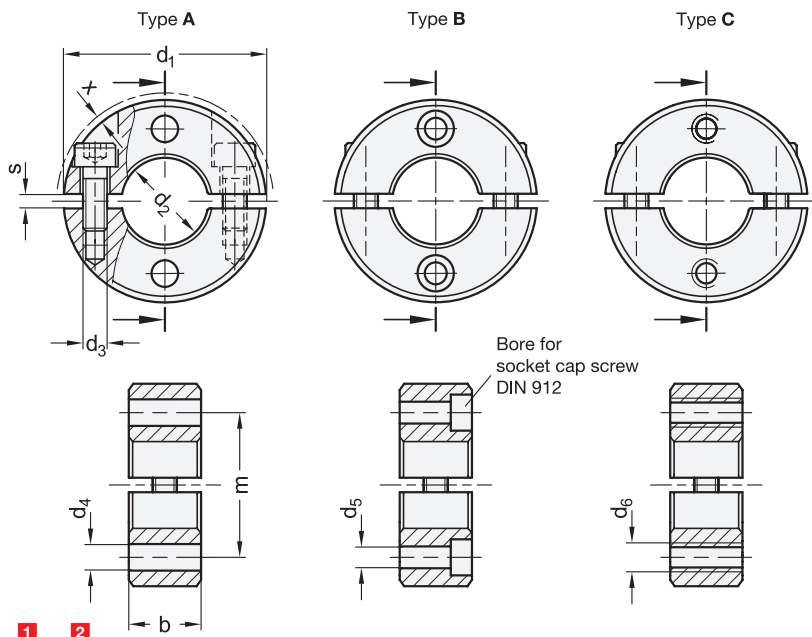

ROSTFREI
Inox
Stainless
Steel

4 Type

- A** with two through holes
- B** with two countersunk holes for socket head cap screws
- C** with two tapped holes

d ₁	d ₂ H10 recommended shaft tolerance h11		b ±0,2	d ₃	d ₄	d ₅	d ₆	m		s	x ≈ max. protrusion of cap screw	Adjustable hand lever for d ₃
	Bore series 1	Bore series 2						Bore series 1	Bore series 2			
30	B 12	-	11	M 4	4,5	3,5	M 4	21	-	2,1	0,7	GN 311-30-M4-12-SW
32	B 14	-	11	M 4	4,5	3,5	M 4	23	-	2,1	0,7	GN 311-30-M4-12-SW
36	B 15	B 16	13	M 5	5,5	4,5	M 5	25,5	26	2,1	1,4	GN 311-30-M5-13-SW
42	B 18	B 20	15	M 5	5,5	4,5	M 5	30	31	3	0,6	GN 311-30-M5-15-SW
48	B 22	B 25	15	M 5	6,5	5,5	M 6	35	36,5	3	0	GN 311-45-M5-16-SW
55	B 28	B 30	15	M 6	6,5	5,5	M 6	41,5	42,5	3	0,5	GN 311-45-M6-18-SW
60	B 32	B 35	15	M 6	6,5	5,5	M 6	46	47,5	4	0,4	GN 311-45-M6-19-SW
65	B 40	-	15	M 6	6,5	5,5	M 6	52,5	-	4	0,5	GN 311-45-M6-20-SW

Specification

- Stainless Steel Sintered Steel AISI 316 LHC
- Socket cap screw DIN 912 Stainless Steel AISI 304
- ISO-Fundamental tolerances → Main Catalogue Page 1479
- Stainless Steel characteristics → Main Catalogue Page 1489
- RoHS

Accessory

- Adjustable hand levers GN 311 → Page 22
- Dampening washer GN 7072.30 → Page 24

3 Information

NI With split Stainless Steel-Shaft collars GN 7072.2, e.g., axles are attached to housing, or wheels and washers are installed on shafts.

They can be assembled safely and easily with a high clamping force by reducing the slot height, without damaging the surface of shafts and axles. As compared to semi-split shaft collars, split shaft collars can even be assembled radially.

The thread d₃ for sizes d₁ = 30 to 36 is designed as a through hole; for sizes d₁ = 42 and larger, it is designed as blind hole.

see also...

- Semi-split Stainless Steel-Shaft collars GN 7062.2 (with flange holes) → Page 12
- Semi-split shaft collars GN 706.2 → Page 10

How to order	1	d ₁
	2	d ₂
	3	Material
	4	Type
GN 7072.2-42-B18-NI-B		

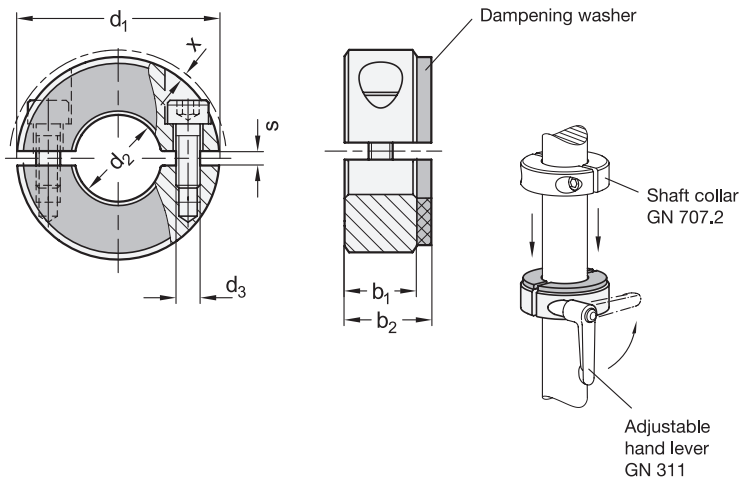

ROSTFREI
Inox
Stainless
Steel

d₁	d₂ H10 recommended shaft tolerance h11		b₁	b₂	d₃	s	x ≈ max. protrusion of cap screw	Adjustable hand lever for d ₃ 
30	B 12	-	11	13	M 4	2,1	0,7	GN 311-30-M4-12-SW
32	B 14	-	11	13	M 4	2,1	0,7	GN 311-30-M4-12-SW
36	B 15	B 16	13	15	M 5	2,1	1,4	GN 311-30-M5-13-SW
42	B 18	B 20	15	18	M 5	3	0,6	GN 311-30-M5-15-SW
48	B 22	B 25	15	18	M 5	3	0	GN 311-45-M5-16-SW
55	B 28	B 30	15	18	M 6	3	0,5	GN 311-45-M6-18-SW
60	B 32	B 35	15	18	M 6	4	0,4	GN 311-45-M6-19-SW
65	B 40	-	15	18	M 6	4	0,5	GN 311-45-M6-20-SW

Specification

- Stainless Steel **NI**
Sintered Steel AISI 316 LHC
- Dampening washer
Elastomer (PUR)
- 70 Shore A
- temperature resistant up to 80 °C
- transparent
- Socket cap screw DIN 912
Stainless Steel AISI 304
- ISO-Fundamental tolerances
→ Main Catalogue Page 1479
- Elastomer characteristics
→ Main Catalogue Page 1483
- Stainless Steel characteristics
→ Main Catalogue Page 1489
- RoHS

Accessory

- Adjustable hand levers GN 311 → Page 22

Information

The affixed dampening washer of the split Stainless Steel-Shaft collars GN 7072.3 absorbs mild shocks and has a sound-dampening effect when the shaft collars come into contact with other components.

They can be assembled safely and easily with a high clamping force by reducing the slot height, without damaging the surface of shafts and axles. As compared to semi-split shaft collars, split shaft collars can even be assembled radially.

The thread d₃ for sizes d₁ = 30 to 36 is designed as a through hole; for sizes d₁ = 42 and larger, it is designed as blind hole.

see also...

- Semi-split Stainless Steel-Shaft collars GN 7062.3 (with dampening washer) → Page 13
- Split shaft collars GN 707.2 → Page 17

How to order

GN 7072.3-42-B18-NI

1	d₁
2	d₂
3	Material

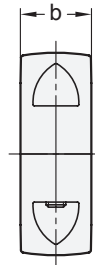
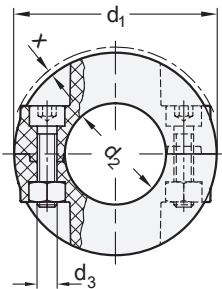

ELESA original design ANPS

Inox
Stainless
Steel

1

2

d ₁	d ₂ recommended shaft tolerance h11			b	d ₃	x ≈	max. recommended tightening torque in Nm
35	B 12	B 14	B 16	13	M 4	1	2
40	B 18	B 20	-	14	M 4	0,75	2
50	B 22	B 25	B 30	14	M 5	2,4	3
65	B 35	B 40	-	14	M 5	0,2	3

Specification

3

- Plastic
Technopolymer (Polyamide PA)
- glass fiber reinforced
- temperature resistant up to 80 °C
- black-gray, matte ● SG
- Socket cap screw DIN 912
Stainless Steel AISI 316L
- Hexagon nut DIN 934
Stainless Steel AISI 316L
- ISO-Fundamental tolerances
→ Main Catalogue Page 1479
- Plastic characteristics
→ Main Catalogue Page 1483
- Stainless Steel characteristics
→ Main Catalogue Page 1489
- RoHS

Information

Split shaft collars GN 707.5 can be assembled radially, e.g., on cables, shafts and axles as an end stop. The clamping is done by reducing the slot height, wherein the surface is properly protected by the plastic.

Combined with the stainless steel screws and nuts, the extremely light-weight plastic elements are particularly suitable for use in corrosive environments.

How to order

GN 707.5-35-B14-SG

1	d ₁
2	d ₂
3	Color

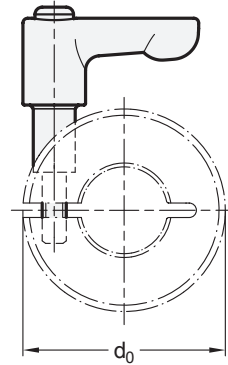
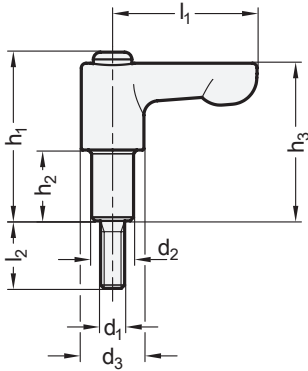

d_0 = Shaft collar $\emptyset d_1$	1 l_1	2 d_1	3 h_2	d_2	d_3	l_2	h_1	h_3
30 / 32	30	M 4	12	7,2	13	12	32	30
36	30	M 5	13	8,7	13	14	33,5	31
42	30	M 5	15	8,7	13	14	35	33
48	45	M 5	16	8,7	13	16	36,5	34
55	45	M 6	18	10	13	16	38,5	36
60	45	M 6	19	10	13	16	39,5	37
65	45	M 6	20	10	13	18	40,5	38

Specification

- Handle
Zinc die casting
plastic coated
black, RAL 9005, textured finish **● SW**
- Threaded insert
Stainless Steel AISI 303
- Retaining screw
Stainless Steel AISI 304
- *Stainless Steel characteristics*
→ Main Catalogue Page 1489
- RoHS

Information

For shaft collars of the standard families GN 706... and GN 707..., adjustable hand levers GN 311 replace the hexagon socket screw DIN 912. That allows the shaft collars to be adjusted easily and quickly without tools.

The table of dimensions of the shaft collars shows the corresponding hand lever for the respective shaft collar size d_1 .

Under GN 706.4, semi-split shaft collars GN 706.2 are generally offered with clamping levers.

see also...

- *Semi-split shaft collars GN 706.2* → Page 10
- *Split shaft collars GN 707.2* → Page 17

How to order

GN311-30-M5-15-SW

1	l_1
2	d_1
3	h_2
4	Color

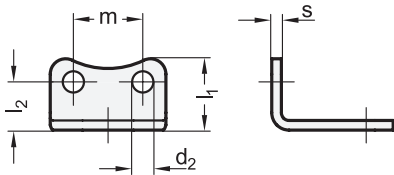

Top views for various bore- $\varnothing d_1$

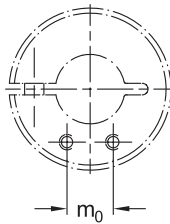

Shaft collar
GN 7062.1 / GN 7072.1



Rostfrei®
Inox
Stainless
Steel

3 Type
L angled

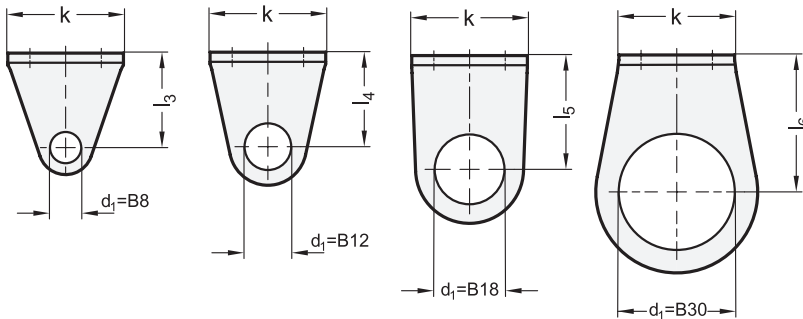

1

2

m_0	$d_1 +0,1$				k	d_2	l_1	l_2	l_3	l_4	l_5	l_6	m	s
8	B 8	B 12	-	-	14	3,5	13	9,5	15	19	-	-	8	2
10	B 8	B 12	B 18	-	18	4,5	14,5	10,5	19	24,5	29,5	-	10	2
12	B 8	B 12	B 18	B 30	23	4,5	17	12,5	19	24,5	29,5	35,5	12	2,5
18	B 8	B 12	B 18	B 30	30	5,5	18,5	12,5	24,5	24,5	29,5	35,5	18	2,5

Specification

- Stainless Steel AISI 304
matte shot-blasted
- *Stainless Steel characteristics*
→ Main Catalogue Page 1489
- RoHS

Information

The Stainless Steel-Sensor holders GN 7062.10 are designed for holding sensors attached with two lock nuts.

The holes d_2 match the extension-tapped holes of the shaft collars GN 7062.1 / GN 7072.1 in measurement and facilitate axial or radial positioning of sensors.

see also...

- *Semi-split Stainless Steel-Shaft collars GN 7062.1*
(with extension-tapped holes) → Page 11
- *Split Stainless Steel-Shaft collars GN 7072.1*
(with extension-tapped holes) → Page 18

How to order

GN 7062.10-B18-30-L

1 **2** **3**

1	d_1
2	k
3	Type

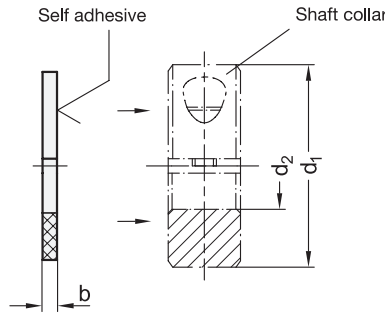
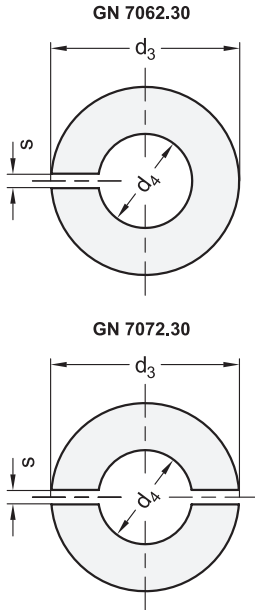

1

2

Dimension of matching shaft collars			Dimension dampening washers				
d ₁	d ₂		d ₃	d ₄		b ±0,2	s
	Bore series 1	Bore series 2		Bore series 1	Bore series 2		
30	B 12	-	28	13	-	2	2,1
32	B 14	-	30	15	-	2	2,1
36	B 15	B 16	34	16	17	2	2,1
42	B 18	B 20	39	19,5	21,5	3	3
48	B 22	B 25	45	23,5	26,5	3	3
55	B 28	B 30	52	29,5	31,5	3	3
60	B 32	B 35	57	33,5	36,5	3	4
65	B 40	-	62	41,5	-	3	4

Specification

- Elastomer (PUR)
 - 70 Shore A
 - temperature resistant up to 80 °C
 - transparent
- Adhesive film
 - acrylate dispersion, solvent-free
 - strong adhesion
- *Elastomer characteristics*
→ Main Catalogue Page 1483
- RoHS

Information

Dampening washers GN 7062.30 / GN 7072.30 are designed as accessories for split and semi-split shaft collars and are attached with the help of an adhesive film, preferably on the groove-less side of the shaft collar. They absorb mild shocks and have a sound-dampening effect when the shaft collars come into contact with other components.

Generally, after the protective film is removed, the dampening washers can be attached to any suitable and clean surface.

Semi-split Stainless Steel-Shaft collars GN 7062.3 and split Stainless Steel-Shaft collars GN 7062.3 are generally offered with assembled dampening washers.

How to order (for semi-split shaft collars)

GN 7062.30-42-B18

1 d₁

2 d₂

How to order (for split shaft collars)

GN 7072.30-42-B18

1 d₁

2 d₂

Otto Ganter GmbH & Co. KG

Triberger Straße 3
78120 Furtwangen
Germany

Tel. +49 7723 6507-0

Mail info@ganternorm.com

www.ganternorm.com