

**Application example**

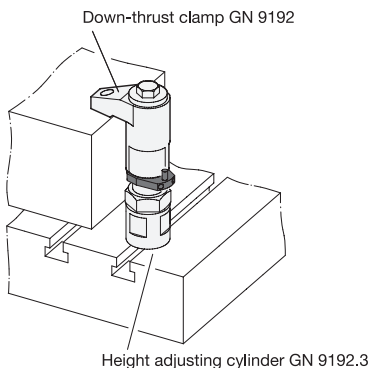
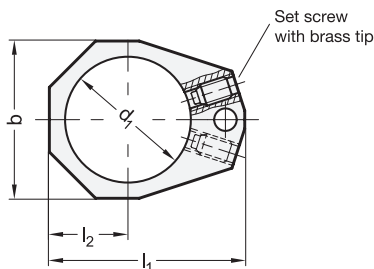

<sup>1</sup> d <sub>0</sub>	<sup>2</sup> d <sub>1</sub>	<sup>2</sup> h <sub>1</sub>	b	d <sub>2</sub>	h <sub>2</sub>	l <sub>1</sub>	l <sub>2</sub>
Down-thrust clamp Ø GN 9192							
40	28	7	35	5	16	43,5	17,5

**Specification**

**Positioning ring**

Steel  
Blackened

**Set screws**

Steel  
• Blackened  
• Brass tip

RoHS

Positioning rings GN 9192.2 limits the swiveling range of down-thrust clamps GN 9192 to 110° left or right via a positioning pin. The position of the ring can be adjusted to ensure that the clamping position is reached reliably when the clamp swivels against the positioning pin.

The positioning ring is secured with two set screws. The stroke of the down-thrust clamp is reduced by the height h<sub>1</sub> of the positioning ring.

see also...	Page
GN 9192 Down-Thrust Clamps	QVX
GN 9192.3 Height Adjusting Cylinders	QVX

**How to order**

<b>GN9192.2-28-7</b>	<sup>1</sup> d <sub>1</sub>
	<sup>2</sup> h <sub>1</sub>

1.1  
1.2  
1.3  
1.4  
2.1  
2.2  
2.3  
2.4

