

- 3

Type
- L

Left indexing cam
- R

Right indexing cam
- 4

Identification no. chamfered pin
- 1

Chamfer, top
- 2

Chamfer, bottom
- 3

Chamfer, right
- 4

Chamfer, left
- 6

Identification no. catch
- 1

Without catch
- 2

With catch

b ₁	s	a	h ₁	k ₁ min.	l ₁ ≈	l ₂	l ₃	l ₄	l ₅	l ₆	l ₇	Spring load in N ≈	
												Initial	End
13	20	6,5	10	1,5	54	10	35	1	37	48	26,5	14	35
20	30	10	15	2	84	15	54	1,5	55	80	40	22	70

Specification

Guide / Catch

• Steel precision casting

- Zinc plated, blue passivated

- Zinc plated and powder coated

Black, RAL 9005, textured finish

• Stainless steel precision casting AISI CF-8

● ZB

● SW

● NI

Plunger pin

• Steel, hardened

Zinc plated, blue passivated for ZB / SW

• Stainless steel AISI 431, hardened for NI

Latch arm

• Steel precision casting

Zinc plated, blue passivated for ZB / SW

• Stainless steel precision casting AISI CF-8 for NI

Pressure spring

Stainless steel AISI 316Ti

RoHS

Technical Information	Page
Application Examples	QVX
List of Cam Action Indexing Plunger Types	QVX
Stainless Steel Characteristics	QVX

Spring latches GN 724.3 have a plunger pin with square cross-section, a latching surface on one side and a chamfer on the other. When moving in the direction of the chamfered pin, the plunger pin passes over grooves and edges, as the chamfered pin moves the plunger pin into the guide. The plunger pin automatically latches into place when moved toward the latching surface. The latching can be released by pulling the latch arm. The notch at the upper end of the curve causes the latch to be held in place if the plunger pin needs to be kept temporarily from protruding. The dimensional tolerances between the pin and the guide have been chosen to ensure functional reliability even in roughly dimensioned applications or in the event of soiling. The latching mechanism is pre-lubricated and can be re-lubricated if necessary. For fastening, slotted or hex mounting holes allow the use of socket cap screws ISO 4762 and hex head screws or nuts according to DIN 931 or DIN 934.

How to order

1

b₁

2

s

3

Type

4

Identification no. chamfered pin

5

Material (Finish)

6

Identification no. catch

1

2

3

4

5

6

GN 724.3-20-30-R 1-NI-2

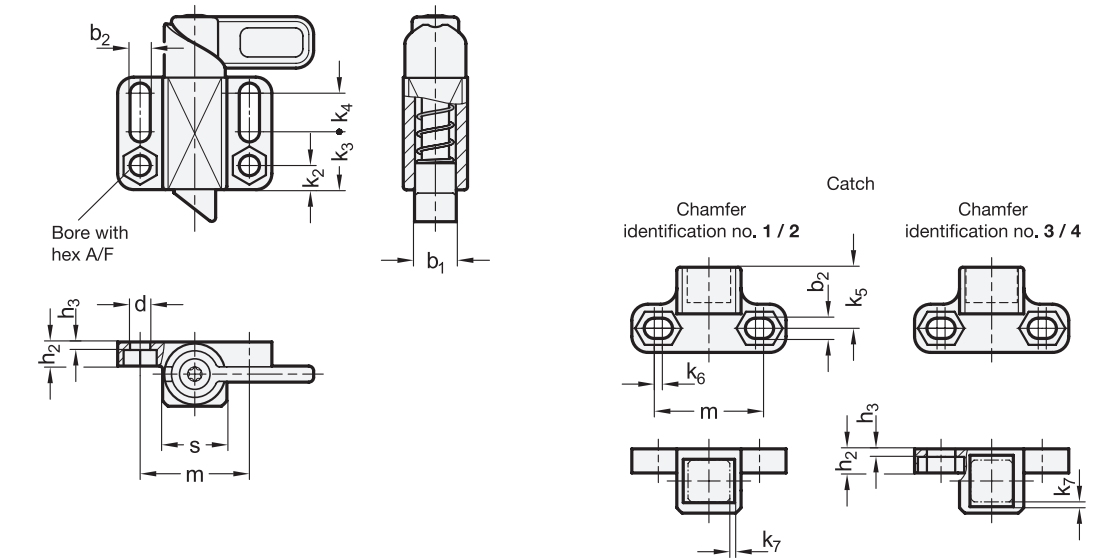

1	2												
b ₁	s	b ₂ +0,3	d +0,2	h ₂	h ₃	k ₂	k ₃	k ₄	k ₅	k ₆	k ₇	m	A/F
13	20	6,1	6,1	7,5	1,5	7,5	18	12	19	2,5	1,5	34	10
20	30	10,1	10,1	14	5	14	34	10	27,5	3	2	55	17

Assembly Examples

