

elesa
Original design GC.-SST

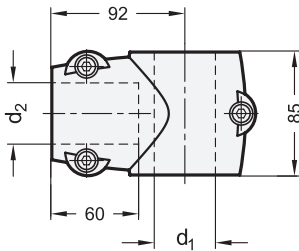

Application example

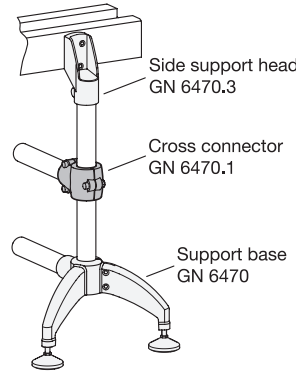

1 d₁		2 d₂	
Bore	Tube nominal size DIN EN 10220 / EN 10255	Bore	Tube nominal size DIN EN 10220 / EN 10255
B 42,4	1 1/4"	B 42,4	1 1/4"
B 48,3	1 1/2"	B 42,4	1 1/4"
B 48,3	1 1/2"	B 48,3	1 1/2"
B 60,3	2"	B 42,4	1 1/4"
B 60,3	2"	B 48,3	1 1/2"

Specification

Connector

- Plastic, polyamide (PA)
- Glass fiber reinforced
- Operating temperature -30 °C to +100 °C
- Black, matte finish

Clamping set

- Stainless steel AISI 304
- Socket cap screws ISO 4762
- Hex nuts DIN 934

RoHS

On request

With square 45 x 45

Cross connectors GN 6470.1 are used with boiler or threaded tubes to build transport systems or work tables. They enable the creation of lateral connections with defined distance and stabilize the structure.

see also...

	Page
GN 6470 Support Bases	QVX
GN 6470.2 Support Heads	QVX
GN 6470.3 Side Support Heads	QVX

Technical Information

Plastic Characteristics	QVX
Stainless Steel Characteristics	QVX

How to order

GN 6470.1-B48,3-B42,4	1	d ₁
	2	d ₂