

Bore for socket cap screw ISO 4762

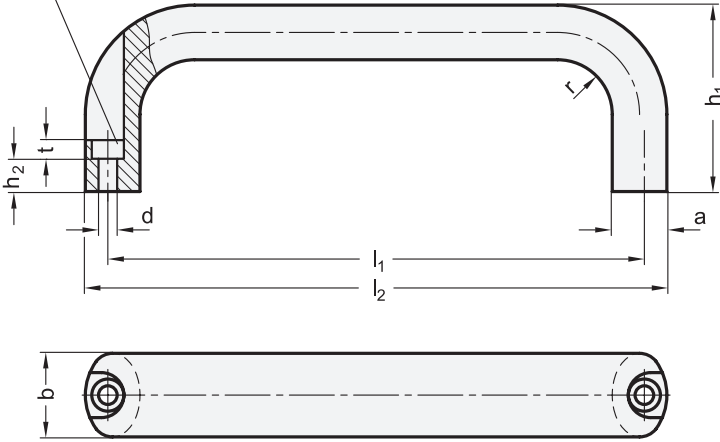

¹ b	² l ₁	a	d	h ₁	h ₂	l ₂	r	t
20	100	13	5,4	49	13,5	112	13	5,5
20	112	13	5,4	49	13,5	124	13	5,5
20	117	13	5,4	49	13,5	129	13	5,5
20	120	13	5,4	51	13,5	132	13	5,5
20	128	13	5,4	51	13,5	140	13	5,5
20	160	13	5,4	51	13,5	172	13	5,5
26	116	17	6,4	55	11	130	17	6
26	120	17	6,4	55	11	134	17	6
26	132	17	6,4	55	11	146	17	6
26	164	17	6,4	57	11	178	17	6
26	179	17	6,4	57	11	193	17	6
26	196	17	6,4	57	11	210	17	6

Specification

Aluminum

- Powder coated,
 - Black, RAL 9005, textured finish UV-resistant
 - Red, RAL 3000, textured finish
 - Silver, RAL 9006, textured finish
- Anodized, natural color
- Plain finish, tumbled

- **SW**
- **RS**
- **SR**
- **EL**
- **BL**

RoHS

Cabinet U-handles GN 565.1 are manufactured from a bent aluminum profile and have excellent stability and ergonomic design.

In addition to the standard surfaces, these cabinet U-handles are also available with a functional coating.

The **SW** version is coated with a highly weather-resistant and UV-resistant powder coating system, making this version excellent for outdoor use.

see also...

	Page
GN 565 Cabinet U-Handles (Mounting from the Back)	QVX
GN 565.5 Cabinet U-Handles (Stainless Steel, Mounting from the Back or the Operator's Side)	QVX
GN 725.1 Cabinet U-Handles (Plastic, Mounting from the Back)	QVX

Technical Information

Load Rating Information	QVX
-------------------------	-----

How to order

GN 565.1-26-132-SW

¹	b
²	l ₁
³	Finish

