

$d_1 = 14...30$

$d_1 = 40$

$d_1 = 55$

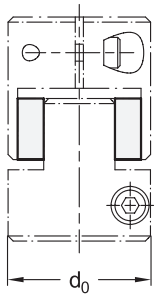
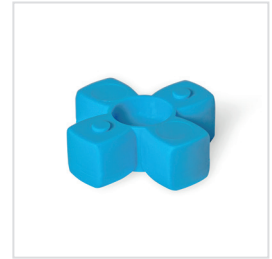
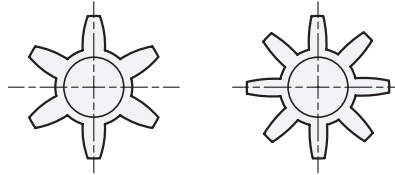
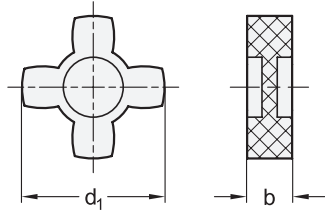

Assembly instruction

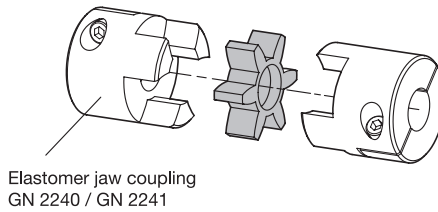

Elastomer jaw coupling
GN 2240 / GN 2241



d_0 Coupling \varnothing GN 2240 / GN 2241	d_1	b	Number of teeth
14	14	6	4
20	20	8	4
30	30	10	4
40	40	12	6
55	55	14	8

Specification

- Thermoplastic polyurethane (TPU)
 - Temperature resistant up to 60 °C
 - Hardness
 - 80 Shore A, blue
 - 92 Shore A, white
 - 98 Shore A, red

BS
WS
RS

- [Elastomer Characteristics](#) → Page 2158
- [RoHS](#)



Information

Coupling spiders GN 2240.1 are intended as replacement parts or for adjusting elastomer jaw couplings GN 2240 / GN 2241.

The choice of three coupling spiders with different hardness values allows the properties of the coupling to be optimally matched to the specific requirements.

see also...

- [Elastomer Jaw Couplings GN 2240 \(with Clamping Hub\)](#) → Page 1680
- [Elastomer Jaw Couplings GN 2241 \(with Grub Screw\)](#) → Page 1682

How to order

GN 2240.1-40-RS

1	d_1
2	Hardness