

Socket cap screw

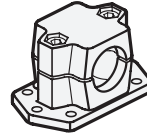

2 Identification no.

- 2 With 2 stainless steel socket cap screws DIN 912

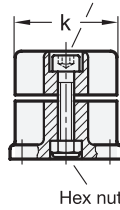
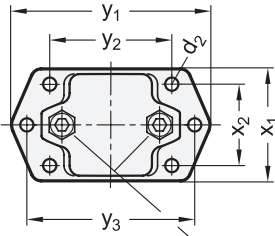

Screw locations z

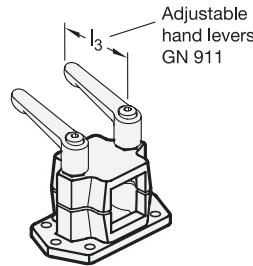

Adjustable hand levers GN 911



d ₁ Bore	s Square	d ₂	k Clamping length	l ₁	l ₂	m	t	x ₁	x ₂	y ₁	y ₂	y ₃	z Screw locations	Accessory Recom. hand lever GN 911 for z l ₃
B 20	V 20	6,5	50	53	68	30	7	55	40	97,5	60	82,5	M8-40	63 78
B 25	V 25	6,5	50	53	68	30	7	55	40	97,5	60	82,5	M8-40	63 78
B 30	V 30	6,5	50	53	68	30	7	55	40	97,5	60	82,5	M8-40	63 78

Specification

- Connector clamp
Aluminum
- Powder coated
Black, RAL 9005, textured finish ● SW
- Plain finish, matte shot-blasted ○ BL
- Socket cap screws DIN 912
Stainless steel AISI 304
- Hex nuts DIN 985
Stainless steel AISI 304
Self-locking via polyamide ring
- Stainless Steel Characteristics → Page 2166
- RoHS

Accessory

- Adjustable Hand Levers GN 911 → Page 1784



Information

The clamping bore of flanged connector clamps GN 147.3 is not machined and designed for construction tubes GN 990 or DIN 2391, DIN 2395 and DIN 2462.

The versions with square bores are also suitable for use with **profile systems**.

At the screw locations **z**, the socket cap screws reduce the bore cross-section for clamping.

For clamping without tools, the socket cap screws can be replaced by the adjustable hand levers GN 911 listed in the table as accessories.

see also...

- Product Family Standard Parts for Profile Systems → Page 18
- Construction Tubes GN 990 → Page 1835

How to order

GN 147.3-B25-2-SW

1	d ₁ (s)
2	Identification no.
3	Finish

