

2 Type

- D** Consisting of three parts
- Z** Consisting of two parts

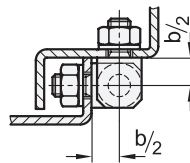
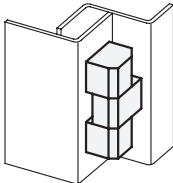
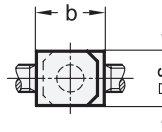

s	b	d ₁	d ₂ Pin	h ₁	h ₂	l ₁	l ₂	l ₃	l ₄ max.	l ₅	l ₆	m ₁	m ₂
12	15	M 6	6	39,2	25,6	10	5	14	9	10	5	27,2	13,6
16	20	M 8	8	49	32,5	14	8	22	16	14	8	33	16,5

Specification

- Steel
Zinc plated, blue passivated
- Pin
Brass, nickel plated
- Washer
Brass, nickel plated
- Hexagon nut ISO 4032
Steel zinc plated, blue passivated
- Serrated washer DIN 6797
for securing screws
Steel zinc plated, blue passivated
- Load Rating Information → Page 2121
- RoHS

Information

Hinges GN 129 are used for doors which are flush with the frame on the outside. The hinges are normally arranged to the side of the door.

In the two-part design, the door can be unhinged with two identically arranged hinges.

The three-part hinges, which generally cannot be unhinged and are mounted inside, are suitable for doors and flaps which, as anti-tamper precaution, must not be dismountable from the outside.

see also...

- List of Hinge Types → Page 1284 ff.
- Hinges GN 129.2 (Steel / Stainless Steel) → Page 1328
- Hinges GN 129.3 (Steel) → Page 1329

How to order

GN 129-16-D

- 1** s
- 2** Type