

Examples of application

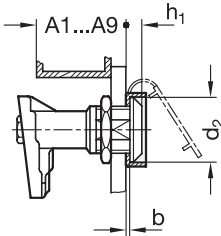

Latches GN 119

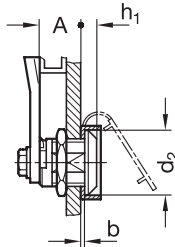

Latches GN 115

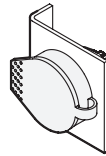

d ₁	s	b	h ₁	h ₂	Length l	useable for * d ₂	GN 115	GN 115.1	GN 115.6	GN 115.8	GN 115.9	GN 119	GN 515	GN 516	GN 516.1	GN 516.5
29	14,5	2	6	11	18,5	20 / 22	-	x	x	-	-	-	-	-	-	-
36	20,5	2	8	12	23	28 / 30 / 32	x	-	-	x	x	x	x	x	x	x

* Used for latches actuated by key / socket key

Specification

- Plastic (Polyethylene)
Black
- *Plastic Characteristics* → Page 2158
- **RoHS**

Information

Protective caps GN 120 are used in combination with key-actuated locking devices. These prevent dirt from entering the key mechanism and the locking device and can be mounted as required in a 90° grid pattern together with the housing of the locking device.

Please note: The clamping range A1 ... A9 and/or the latch distance A is reduced by the dimension b.

see also...

- *List of Latch Types* → Page 1196 ff.
- *Protective Guide Plates GN 120.2* → Page 1270
- *Internal Cabinet Handles GN 120.3* → Page XYZ

How to order

GN 120-36-20,5

1 d₁

2 s